

ILLUSTRATION #300

Report: PARTS LIST

REF.	DESCRIPTION	QTY	SUPPLIER PN (A)	PART NO. (A)	SUPPLIER PN (B)	PART NO. (B)	SUPPLIER PN (C)	PART NO. (C)
101	PIPE FRAME	1	2101-2440	82441-101	2101-2460	82441-130	2101-2470	82441-131
102	ENG BASE	1	2107-1040	82441-102				
103	FUEL TANK	1	51002-6029-9R	82441-103				
104	FUEL STRAINER	1	395686-66611A	82441-104				
105	FUEL CAP	1	51048-2055	82441-105				
106	HOSE CLAMP	2	316666-6812B	82441-106				
107	FUEL TANK STAY	2	9113-0230	82441-107				
108	HOSE	1	705A0910000	82441-108				
109	ENGINE SHOCK MOUNT	4	0222-0540	82441-109				
110	WELDER SHOCK MOUNT	2	0222-0550	82441-110				
111	LIFT BAR	1	2113-0210	82441-111				
112	BATTERY	1	9101-0140	82441-112				
113	BATTERY PAD	1	2205-0160	82441-113				
114	BATTERY RETAINER	1	212-0230	82441-114				
115	BATTERY RETAINER BOLT	2	2202-0160	82441-115				
116	BATTERY TERMINAL	2	9204-0030	82441-116				
117	CONTROL BOX SHOCK MOUNT	4	0222-0001	82441-117				
118	REACTOR BASE	1	2124-0030	82441-118	2124-0032	82441-136		
119	A/C REACTOR	1	5174-0060	82441-119				
120	CONTROL BOX COVER	1	3139-0160	82441-120	3139-0161	82441-132		
121	FRONT COVER	1	3130-0170	82441-121				
122	BACK COVER	1	3139-0180	82441-122				
123	CURRENT TRANSFORMER	1	5114-0490	82441-123				
124	SOLENOID, IDLE	1	27010-2123	82441-124				
125	BRKT, IDLE SOL	1	5184-0061	82441-125	5184-0070	82441-137	5184-0063	82441-138
126	COVER IDLE SOL.	1	5190-0070	82441-126	5190-0080	82441-133	5190-0090	82441-134
127	CABLE IDLE SOL		54012-2251	82441-127	54012-2278	82441-135		
201	FRONT PANEL BARE	1	5102-0560	82441-201				
202	RANGE SELECTOR	1	5135-0400	82441-202				
203	RANGE SELECTOR KNOB	1	5119-0200	82441-203				
204	AMPERE REGULATOR	1	5110-0250	82441-204				
205	AMPERE REGULATOR KNOB	1	5119-0210	82441-205				
206	VOLTMETER	1	5105-0440	82376-402				
207	MAIN LINE C/B	1	5124-0660	82441-207				
208	MAIN LINE C/B RETAINER	1	5126-0120	82376-427				
209	L6-30 TLR 240V/30A	1	N/A	57324-000				
210	L5-30 LTR 120V/30A	1	N/A	56359-000				
211	5-20 DPR 120V/20A	1	N/A	50766-000				
212	IDLE CONTROL SWITCH	1	5124-0110	82441-212				
213	STARTER SWITCH	1	27005-2052	82441-213				
214	STUD BOLT	2	6104-0289	82376-416				
215	BUSH KIT	2	5203-0050	82376-417				
216	WASHER	12	0109-0013	82376-418				
217	NUT	6	0107-0013	82376-420				

CBS use 97517-2

- Kawasaki

Report: PARTS LIST

8 APRIL 1986

REF.	DESCRIPTION	QTY	SUPPLIER PN (A)	PART NO. (A)	SUPPLIER PN (B)	PART NO. (B)	SUPPLIER PN (C)	PART NO. (C)
218	SPRING WASHER	2	0110-0025	82441-218				
219	WING NUT	2	0124-0002	82376-421				
220	CURRENT TRANSFORMER	1	5114-0610	82441-220				
221	REGULATOR	1	21066-2004	82441-221				
222	AVR	1	5202-1240	82441-222				
223	OIL PRESS CONTROL	1	21177-2054	82441-223				
224	RESISTOR	1	5111-0400	82441-224				
225	SLOW DOWN CONTROL	1	5124-0040	82441-225				
226	RELAY	1	5128-0590	82441-226				
227	RELAY SOCKET	1	5129-0080	82376-310				
228	FUSE	1	5112-0410	82441-228				
229	FUSE HOLDER	1	5113-0120	82441-229				
230	TERMINAL BLOCK	1	5115-0800	82441-230				
231	HEAT DEFLECTOR	1	5190-0060	82441-231				
232	TOP COVER	1	5190-0050	82441-232				
301	END BRACKET	1	1102-2260	82441-301				
302	COVER	1	1120-1740	82441-302				
303	FAN	1	1107-0590	82441-303				
304	STATOR	1	1254-0030	82441-304				
305	BELLY BAND	1	1120-1750	82441-305				
306	ROTOR KIT	1	1299-0030	82441-306				
307	BRUSH HOLDER	1	1114-0190	82441-307				
308	BRUSHES	2	1113-0410	82441-308				
309	DIODE KIT	1	5121-0520	82441-309				
310	DIODE KIT	1	5121-0530	82441-310				
311	BEARING ASSY	1	0120-0005	82441-311				
312	END COVER	1	1102-2270	82441-312	1102-2271	82441-320		
313	THUR BOLT	1	6101-0142	82441-313				
314	STUD	4	6101-0141	82441-314				
315	SIDE COVER (OPP)	1	1120-1760	82441-315				
316	SIDE COVER (SOL.)	1	1120-1861	82441-316	1120-1760	82441-315		

- Winsco Buys same As 82376-311

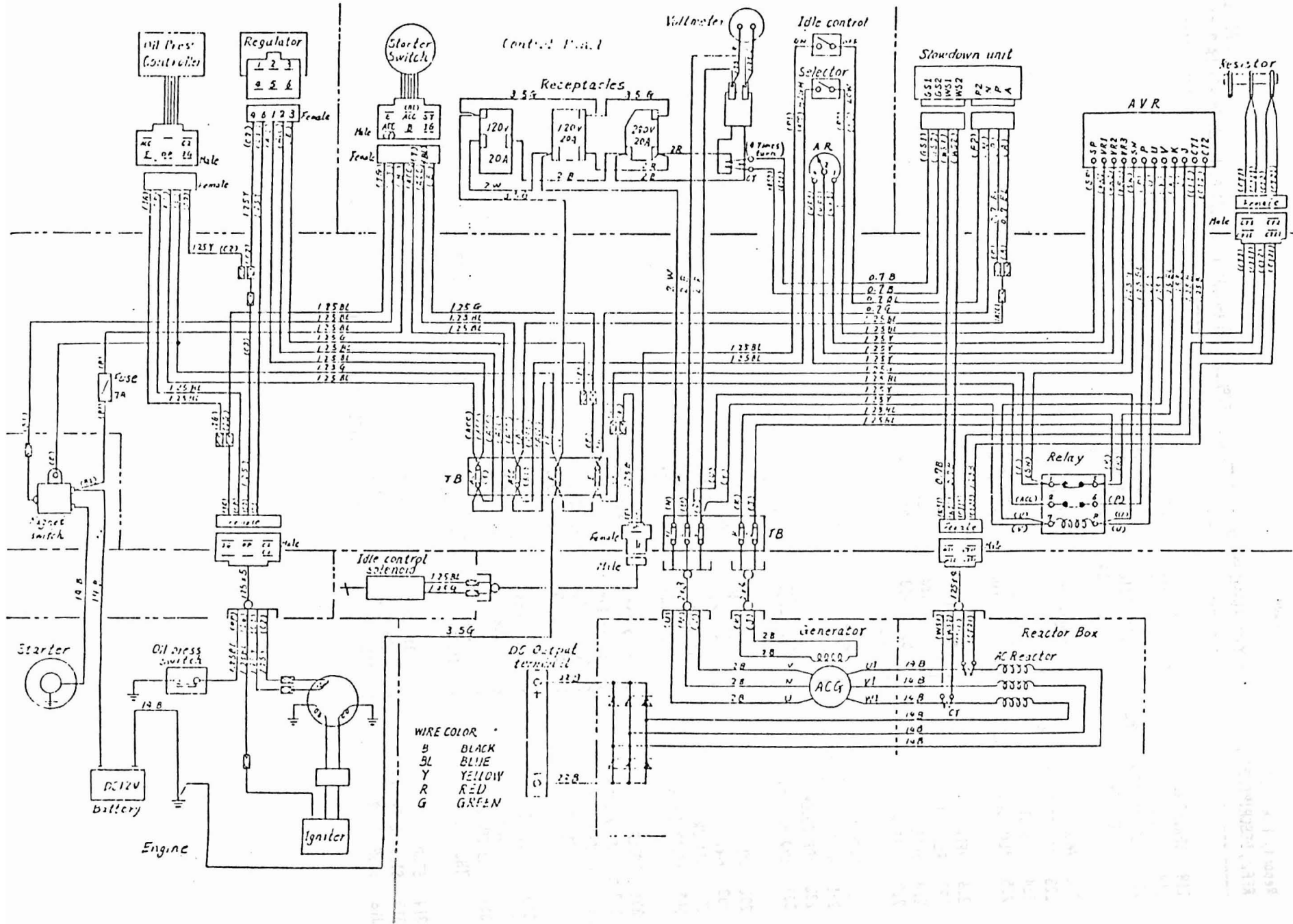

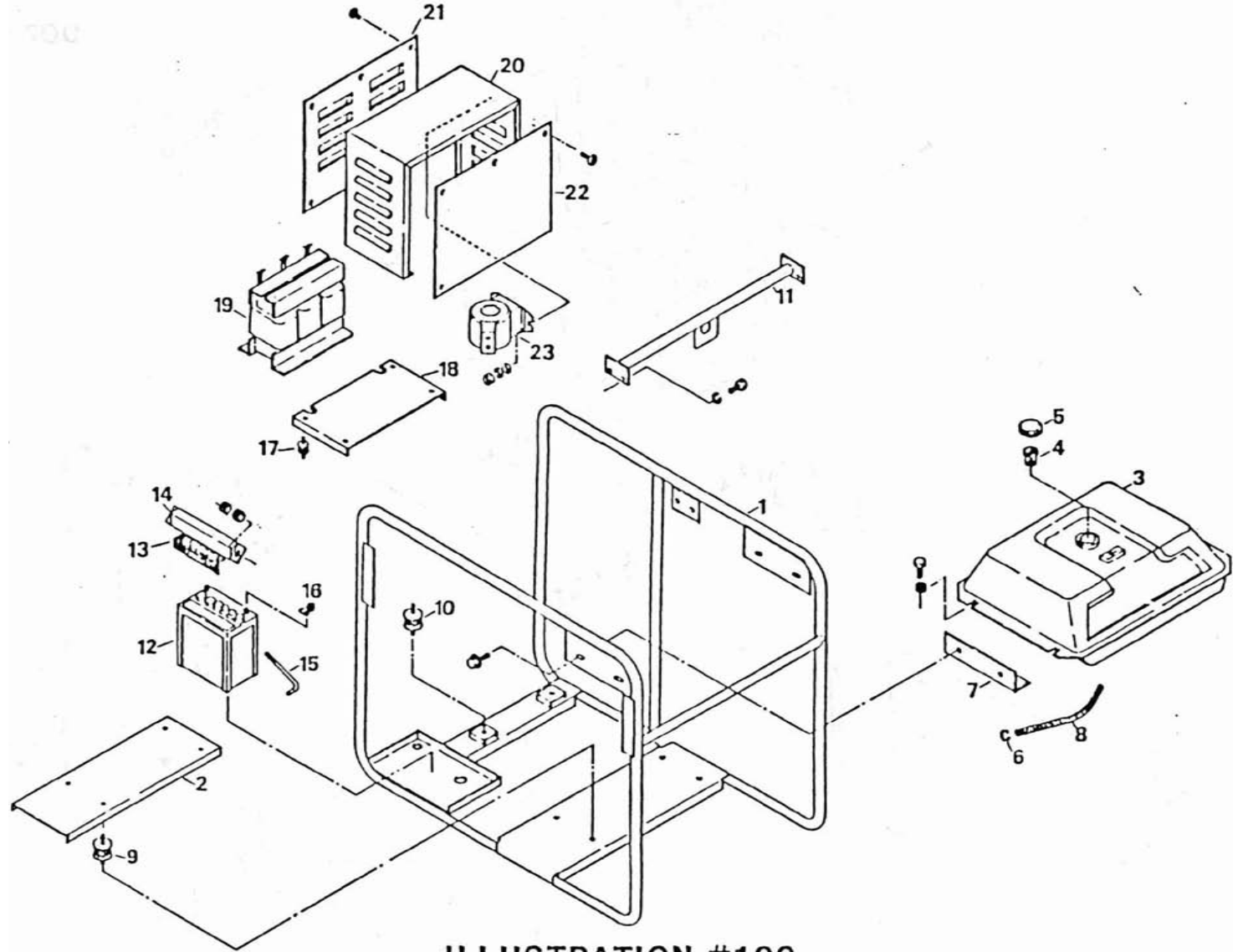
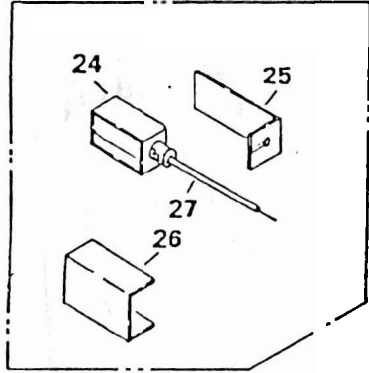
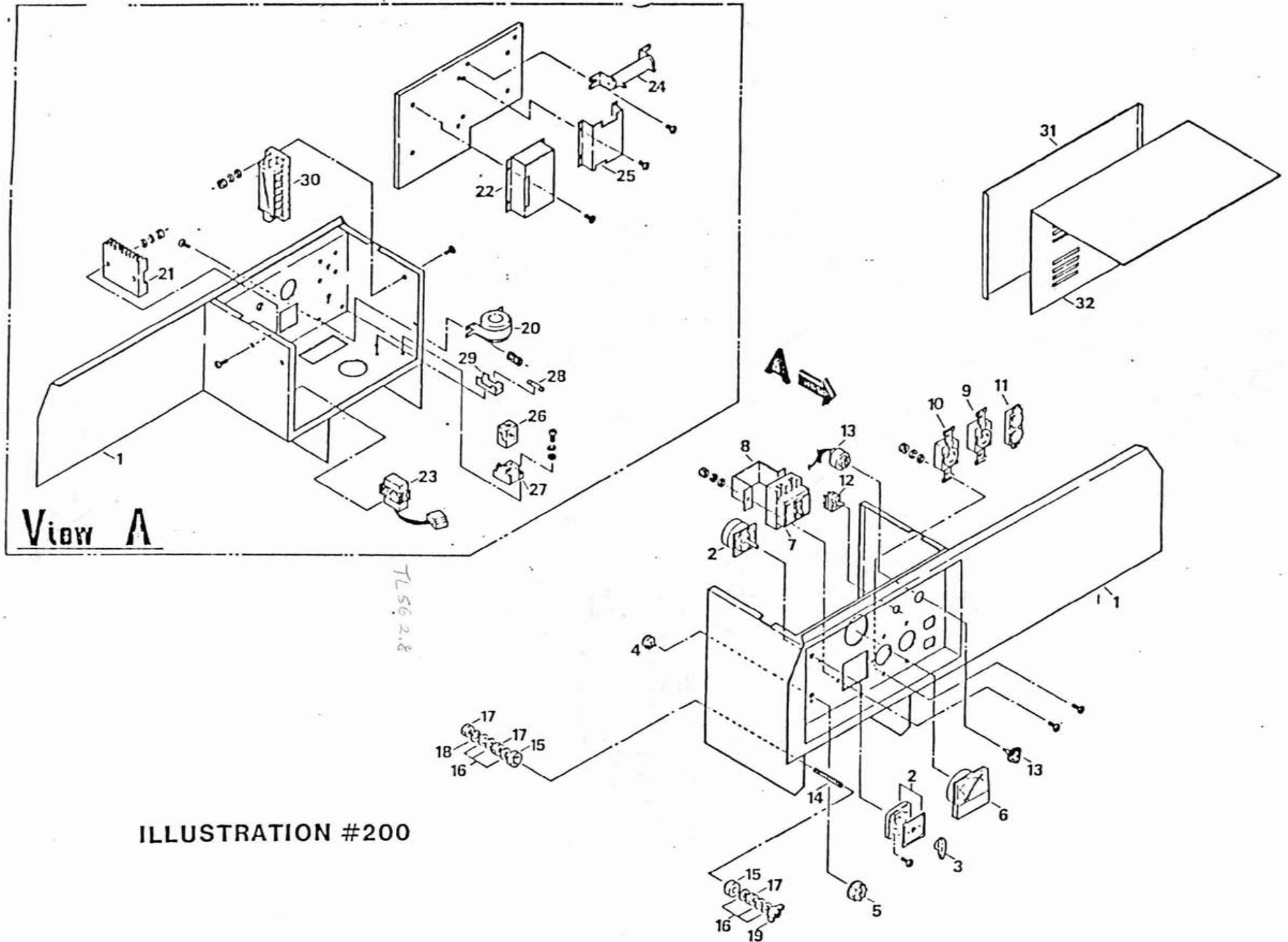
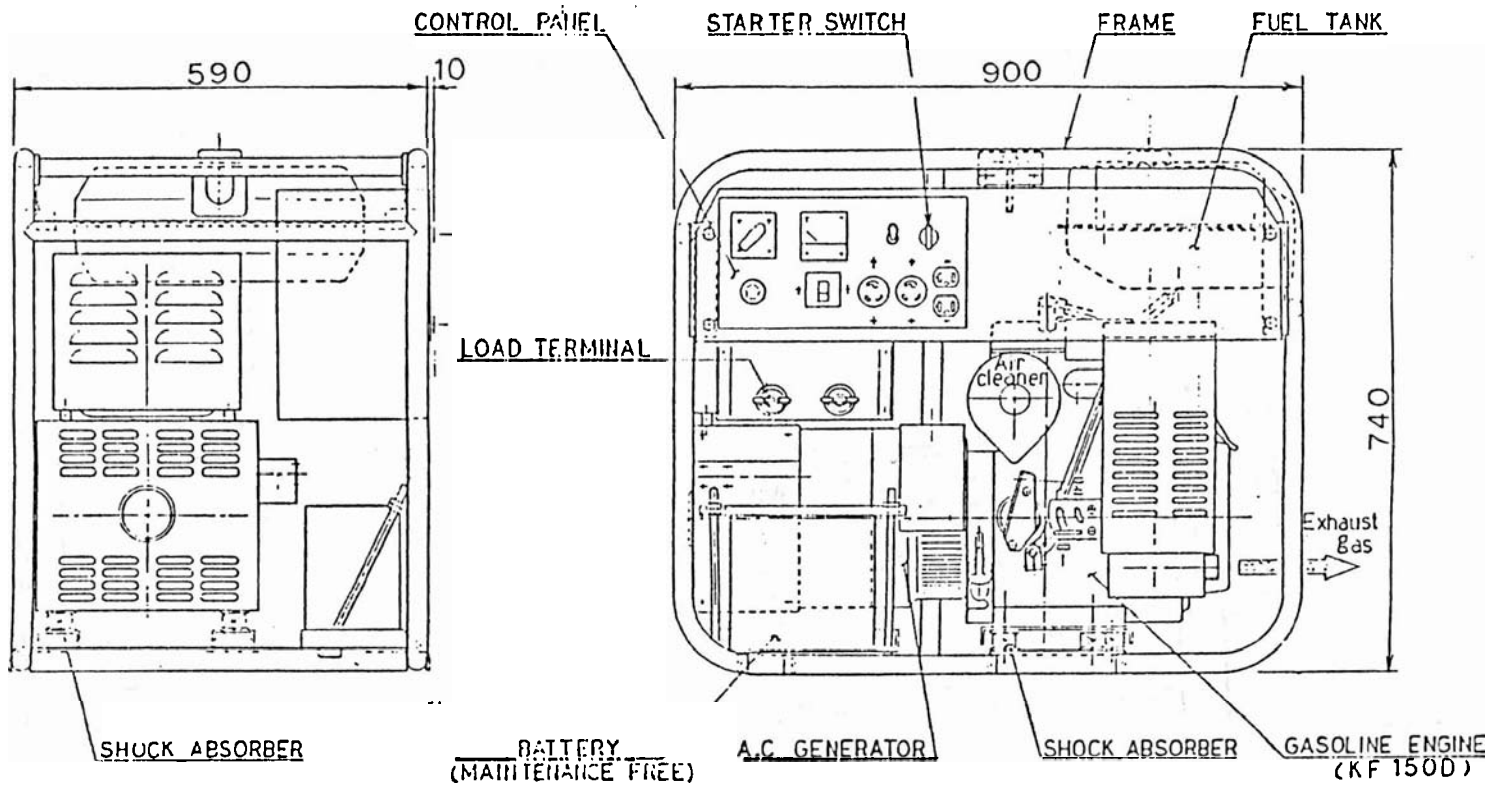

ILLUSTRATION #100



12 volt ac - 110 vdc - Kawasaki part



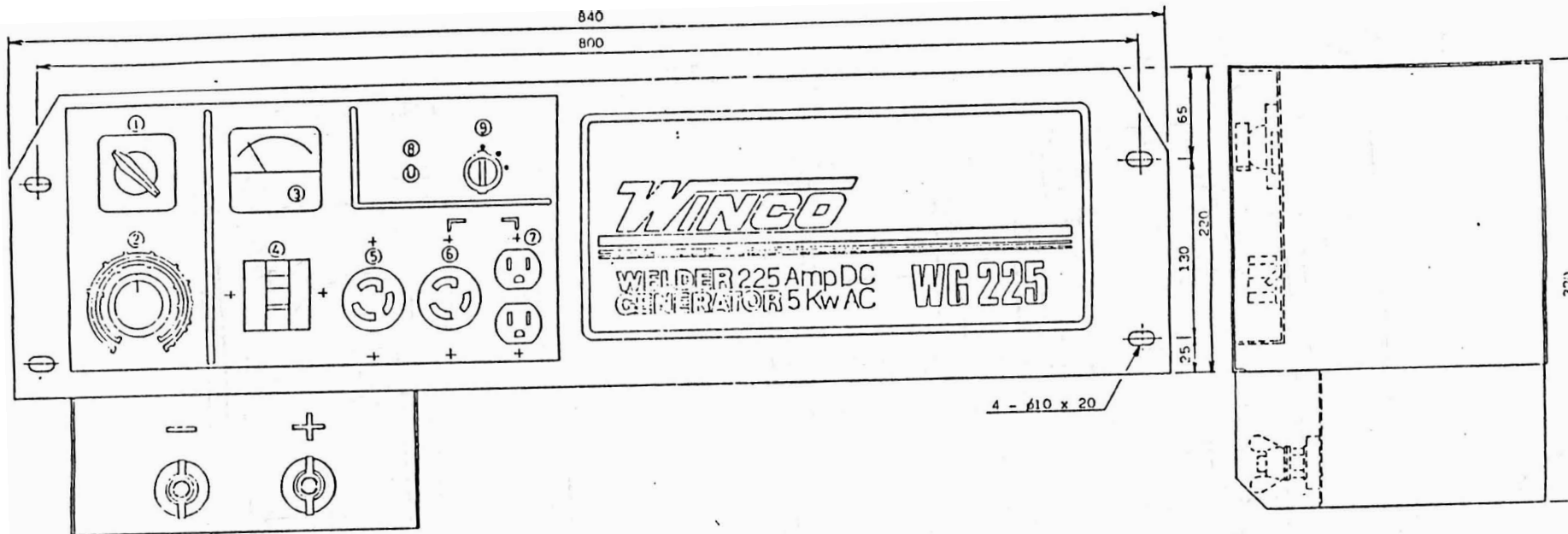

FIG.	NAME
1	RANGE SELECTOR
2	AMPERE REGULATOR
3	VOLT METER
4	MAIN LINE CIRCUIT BREAKER
5	RECEPTACLE (Twistlock) 240volt, 20amp.
6	" ( " ) 120volt, 20amp.
7	" (Duplex) 120volt, 20amp.
8	IDLE CONTROL
9	STARTER SWITCH