

100	Type Drive Engine B & S 190412-1774-01	1	55177
200	Control Panel	1	59068-4
201	Cover	1	59073
206	Ground Strap	3	41387-2
212	Rear Panel	1	59074
240	Front Panel Assembly	1	59071-2
246	Receptacle 230V NEMA 6-20R	1	57642
248	Receptacle Duplex NEMA 5-20R	2	50766
249	Front Panel (Bare)	1	59072-2
270	Saddle	1	56926
272	Rubber Grommet	1	56927
400	Generator	1	51965-3
401	Fan Assembly	1	55101
402	Thru Bolt	1	23197-2
411	End Bracket	1	54178

REF. NO.	DESCRIPTION	QTY.	PART NO.
430	Armature Assembly	1	62115
431	Armature	1	62115-1
432	Bearing	1	55223
	SLIP RING	2	55088
440	Field Shell & Coil Ass'y	1	51964-2
441A	Field Coil	1	51960
441B	Field Coil	1	51960-1
442	Pole Shoe	2	24851
443	Pole Shoe Retainer	2	24849
444	Field Shell & BRACKET	1	56917
445	Stud	4	23451
447	Brush	6	23607
460	Brush Rack Assembly	1	62117
462	Brush Holder	6	59690
463	Capacitor	2	41221
465	Brush Mounting Plate	1	62116
467	Rectifier (Excitation)	1	58976
491	End Cover	1	55007
600	Cradle Assembly		
601	Cradle	1	52121
602	Flat Bar	1	43292
603	Formed Bracket	1	43291
604	Shock Mount	4	23770
611	Foot (Not Shown)	3	20191

**PARTS ORDERING INFORMATION REQUIRED**

To fill your order for service parts, please advise the complete Generator model number and serial number, part number(s), and part description. If in doubt, consult the factory prior to placing the order. Send all parts orders to WINCO, Division of Dyna Technology, Inc., 225 South Cordova Ave., Le Center, MN 56057.



# WINGO<sup>®</sup>

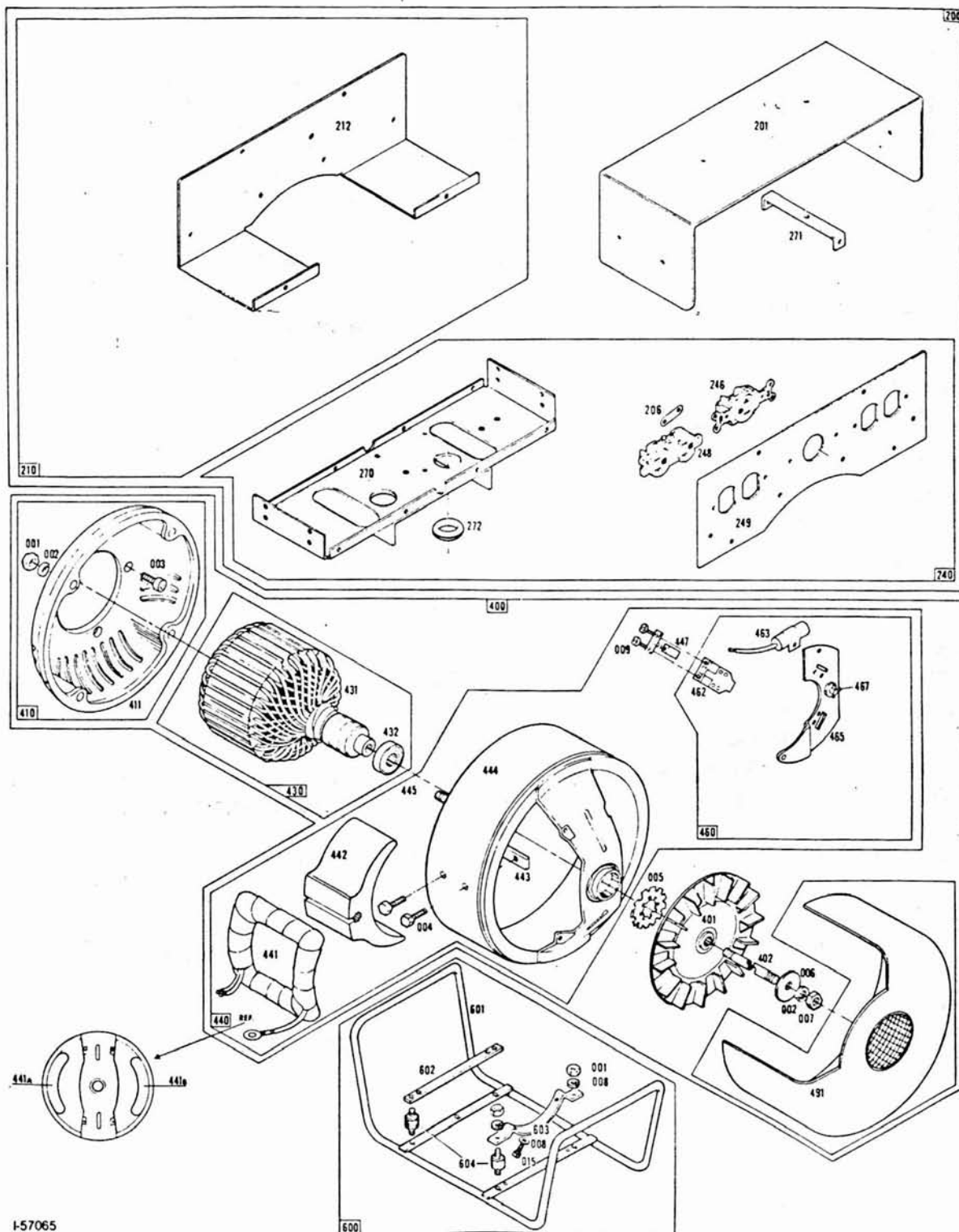

I-57065