

WINCO INC[®]

*A Division of **DT** Dyna Technology Inc*

ILLUSTRATED PARTS LIST

W6010DE/F

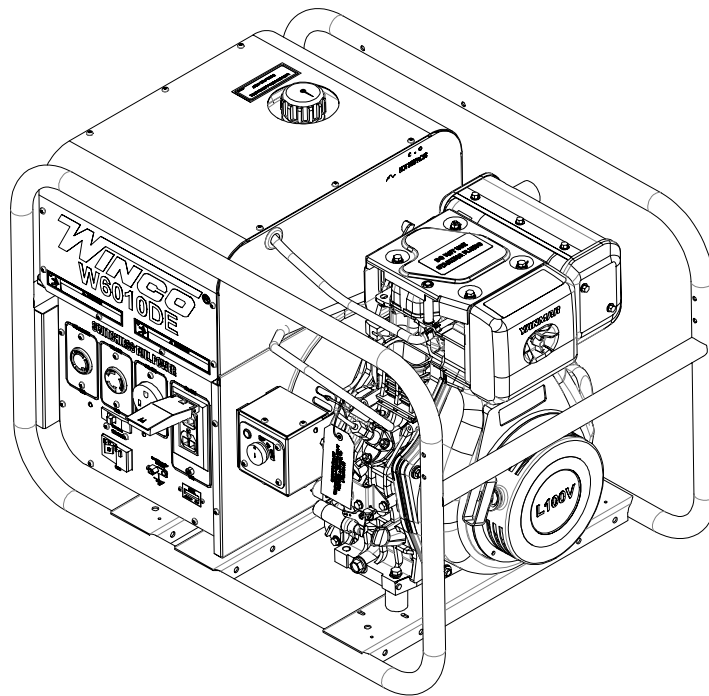

WINCO INC[®]
*A Division of **DT** Dyna Technology Inc*

225 S. CORDOVA AVE.
LECENTER, MN 56057
507-357-6821
SERVICE DEPT.
507-357-6831

ENGINE & GENERATOR ASSEMBLY

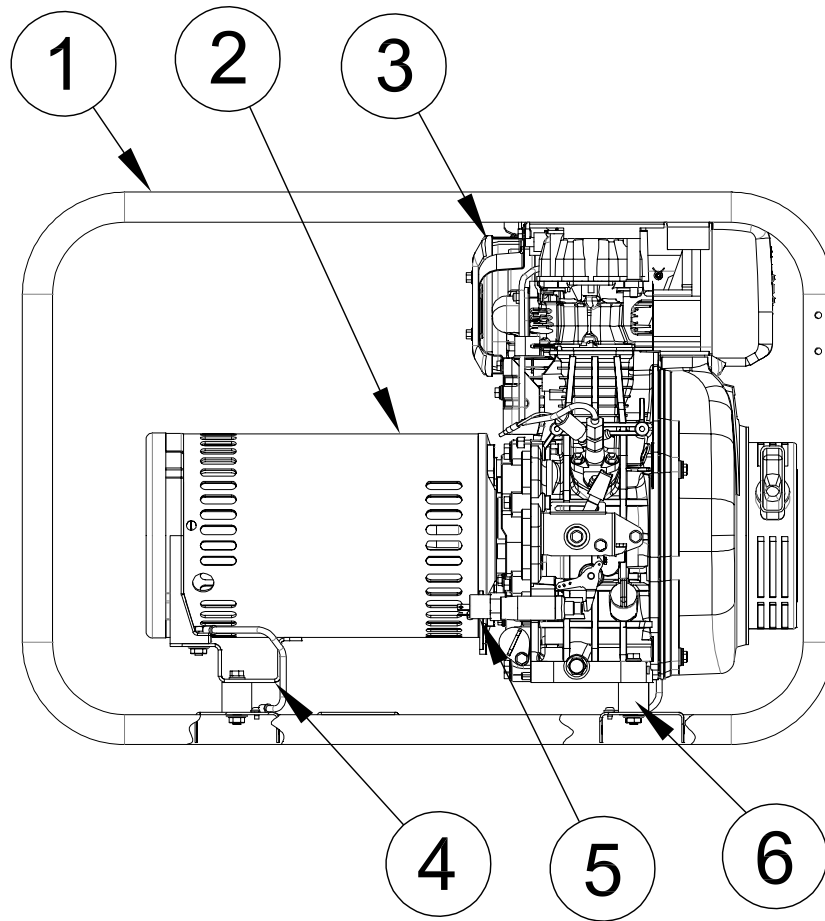

REF #	PART NUMBER	QTY	DESCRIPTION
1	17010-100	1	Cradle
2	15041-036	Reference	Generator Assembly
3	15806-002	1	Engine, Yanmar Model: L100V
4	15084-002	1	Generator Adapter
5	99036-000	1	Oil Pressure Switch
6	64062-000	3	Shock Mount
NI	114250-35110	1*	Oil Filter
NI	114250-55510	1*	Fuel Filter Element
NI	114210-12590	1*	Air Filter
NI	300143	1	Battery Hold Down Kit
*	Yanmar Part #		
NI	Not Illustrated		

BATTERY INSTALLATION

ROUTE POS AND NEG BATTERY CABLES
THROUGH GROMMET IN FUEL TANK
SUPPORT PANEL

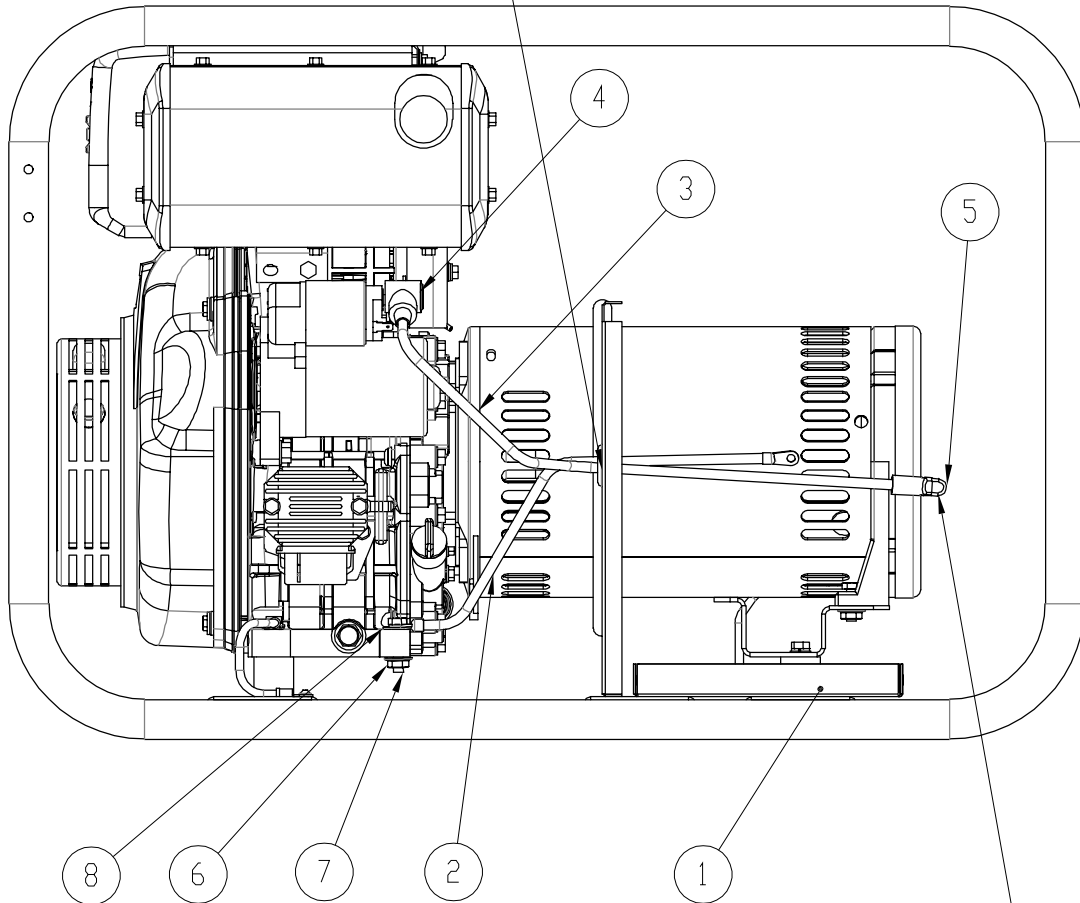

SLIDE RED CAP OVER POS BATTERY WIRE

ITEM NO.	PartNo	DESCRIPTION	QTY.
1	15676-006	BATTERY TRAY	1
2	15767-002	NEG. BATTERY CABLE	1
3	15767-029	POS. BATTERY CABLE	1
4	16145-000	TERMINAL INSULATOR	1
5	16234-000	CAP PLUG	1
6	16249-000	.3125-18 FLANGE	1
7	468-000	.3125-18X1.5 HHCS	1
8	526-000	WASHER ID .375 OD. .890	1

FUEL SYSTEM ASSEMBLY

NOTE:

INSTALL FUEL FILTER AND USE SCREW TYPE CLAMPS (81018-009) TO FASTEN HOSE ENDS TO FILTER, FUEL PETCOCK, AND ENGINE.

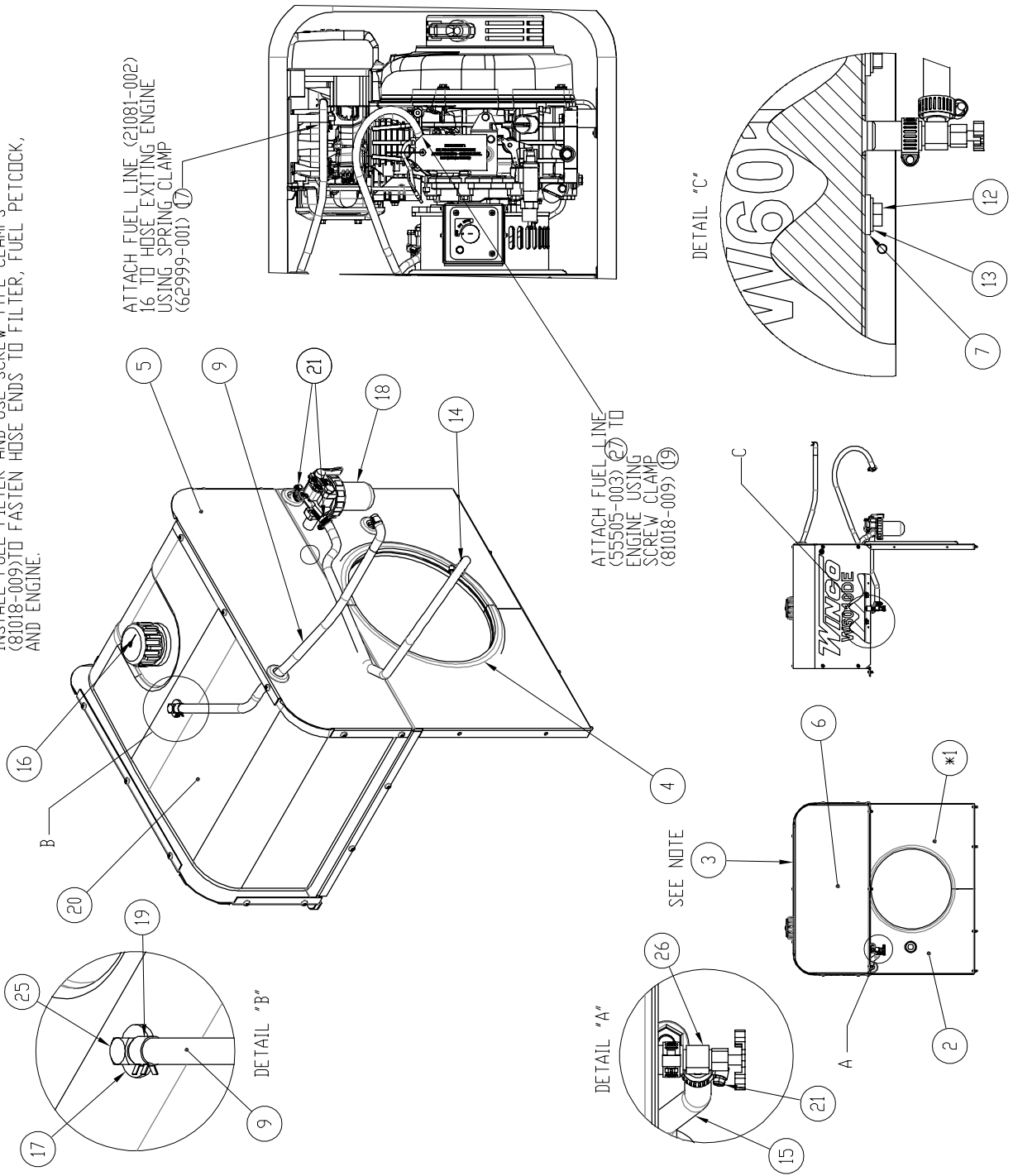

FUEL SYSTEM ASSEMBLY

ITEM NO.	PartNo	DESCRIPTION	QTY
1	15222-028S	FUEL TANK SUPPORT RIGHT	1
2	15223-028S	FUEL TANK SUPPORT LEFT	1
3	15227-017S	COVER	1
4	15287-007	AIR SEAL 16"	2
5	16191-401S	FUEL TRAY	1
6	16191-402S	END BAFFLE	1
7	16133-000	1/4IN LEATHER WASHER	2
8	16249-000	5/16"-18 FLANGE NUT	1
9	21081-002	FUEL LINE 22" CUT	1
10	21698-001	TORX PAN HEAD SCREW #10	29
11	23917-000	GROMMET .6875ID X 1	3
12	466-000	.25-20X.75 HHB	2
13	512-000	.25 WASHER	2
14	55505-003	FUEL LINE 24" CUT	1
15	55505-018	FUEL LINE 9IN CUT	1
16	62396-007	FUEL CAP W/GAUGE 7-3/4" STAINLESS	1
17	62409-000	BUSHING 9/16X1-1/16	1
18	62496-006	FUEL FILTER ASSEMBLY	1
19	62999-001	HOSE CLAMP .5 OD RED	2
20	64024-009	FUEL TANK 7 GAL. DIESEL	1
21	81018-009	HOSE CLAMP .625-.250	5
22	91107-000	5/16-18 X 3.5	1
23	91257-000	PERMATEX	.001 OZ
24	96834-002	SPACER	1
25	98435-000	HOSE FIT. EL. 1/4 HOSE BARB	1
26	98771-003	PETCOCK	1

RECEPTACLE BOX ASSEMBLY

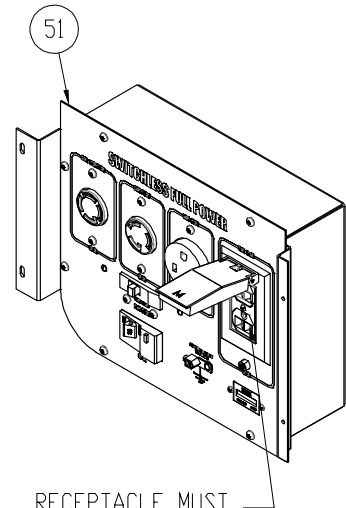
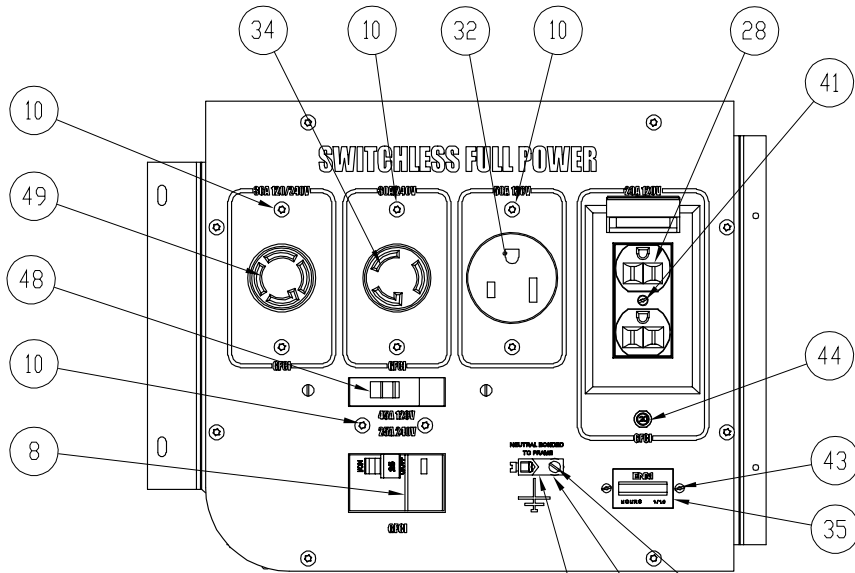

RECEPTACLE MUST BE INSTALLED PRIOR TO COVER USING ITEMS 13, 16, AND 39 THEN COVER CAN BE INSTALLED OVER SCREWS USING ITEM 38 AND 5-20R CENTER HOLE.

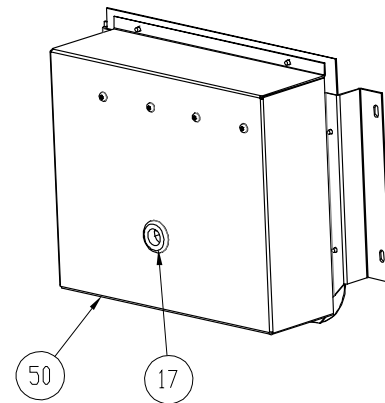
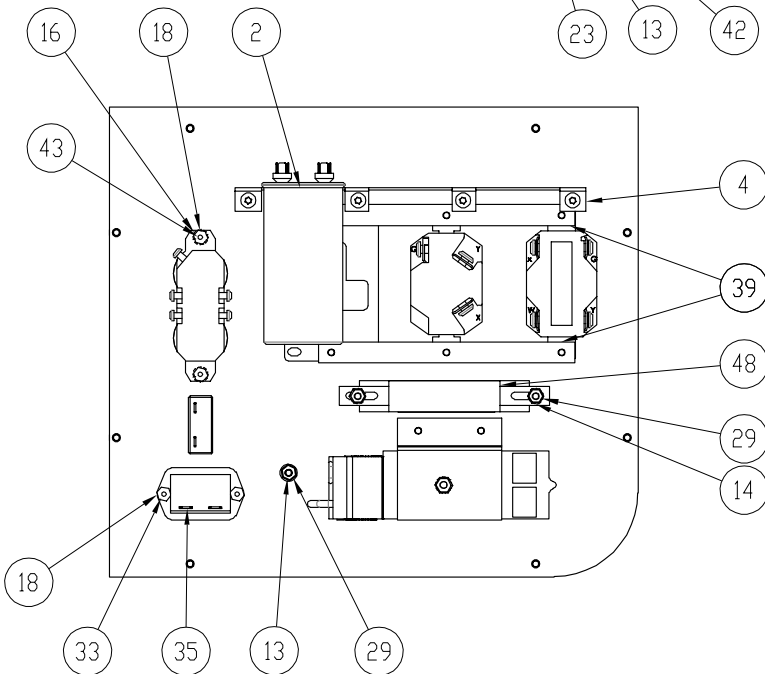

RECEPTACLE BOX ASSEMBLY

ITEM NO.	PartNo	DESCRIPTION	QTY.
1	10468-000	LW 16AWG, BLACK 150°C 600V	1.50 FT
2	15051-000	CAPACITOR, 40MFDS, 370VAC	3
3	15167-000	FOAM - 8.0" LONG	1
4	15226-000	CAPACITOR STRAP	1
5	15620-008	STANDARD DUPLEX COVER 5-20R	1
6	16209-146	SHEET METAL KIT	1
7	16319-000	BRACKET, C.B. MOUNTING	1
8	16488-016	CIR.BRK.25A-2PL-240V-GFCI	1
9	16489-001	2 POLE CIR. BRKR. TERMINAL BLOCK MODIFIED	1
10	21698-001	TORX PAN HEAD SCREW #10	20
13	21975-000	#10 INT. TOOTH LOCKWASHER	2
14	21976-000	#8 LOCKWASHER EXTERNAL TOOTH	2
15	22423-000	LOCKWASHER #10 EXTERNAL TOOTH	1
16	22989-000	#6 LOCKWASHER EXTERNAL TOOTH	2
17	23917-000	GROMMET .6875ID X 1	1
18	394-000	NUT HEX #6-32	4
21	420-000	RHMS 10-24 X .75	1
22	456-000	#10-24 HEX NUT	1
28	50766-000	NEMA 5-20R DUPLEX RECEPTACLE	1
29	5113-000	#8 HEX NUT	3
30	51319-000	SPLICE CAP, COPPER	3
31	51320-000	NYLON INSULATOR	3
32	54545-000	NEMA 5-50R	1
33	566-000	#6 STD. SPLIT LOCKWASHER	2
34	57324-000	NEMA L6-30R	1
35	58166-1	ELAPSED TIME METER	1
38	6402-001	8-32 X .375 BLACK MACHINE SCREW	2
39	64045-006	MOUNTING STRAP - 3 HOLE	2
41	6917-001	RHMS 6-32 X .375 BLACK ZINC	1
42	7614-000	RHMS 8-32 X .75	1
43	7792-001	BZ RHMS 6-32X.5	4
44	91286-001	CIRCUIT BREAKER, 20A, 1 POLE	1
48	91977-006	CIR.BRK. 45A-1PL-240V	1
49	97360-000	RECEPTACLE, L14-30R 120 240V	1
50	16191-202S	RECEPTACLE REAR COVER	1
51	16191-204S	RECEPTACLE FRONT PANEL	1

GENERATOR END ASSEMBLY

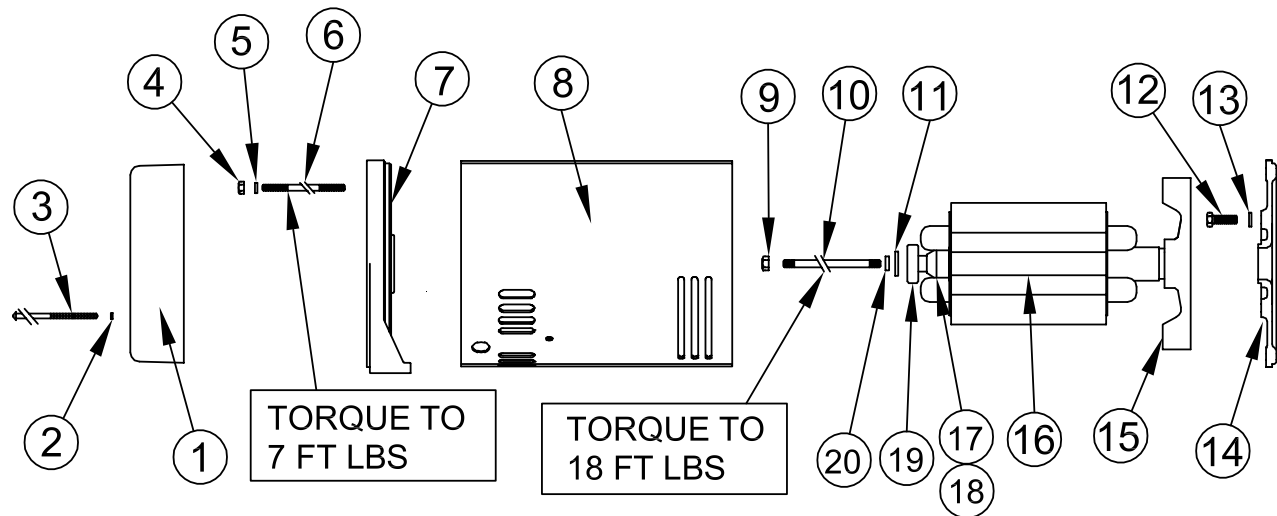

REF #	PART NUMBER	QTY	DESCRIPTION
1	15086-000	1	End Cover Assembly
2	21975-000	4	Lock Washer
3	15013-001	4	Screw
4	15192-000	4	1/4-20 Nut
5	479-000	4	Lock Washer
6	15068-009	4	1/4-20 Bolt / Stud
7	15015-006	1	End Bracket Assembly
8	15091-014	1	Stator Assembly
9	15193-000	1	5/16-24 Nut
10	23197-026	1	5/16-24 Bolt / Stud
11	23558-000	1	Washer
12	96002-040	4	Bolt
13	97436-008	4	Lock Washer
14	15008-000	1	Engine Bracket
15	15136-002	1	Fan
16	15045-011	1	Rotor Assembly
17	15047-001	1	Standard Polarity Diode
18	15047-002	1	Reverse Polarity Diode
19	55223-000	1	Bearing on Rotor Assy
20	480-001	1	Lock Washer
NI	15122-002	1	Tolerance Ring - this comes with fan
NI	Not Illustrated		

DECALS

ITEM NO.	PartNo	DESCRIPTION	QTY
1	15209-002	DECAL-DANGER CARBON MONOXIDE	1
2	15209-003	UL-DECAL ELECTRICAL SHOCK CAN KILL	1
3	15209-102	DECAL-DANGER CARBON MONOXIDE	1
4	15209-103	UL-DECAL ELECTRICAL SHOCK CAN KILL	1
5	60710-018	OIL WARNING TAG	1
6	63941-001	DECAL -HOT SURFACES	1
7	63966-004	NAMEPLATE, WINCO PORTABLE	1
8	64918-000	DECAL-DANGER (CO) USE OUTSIDE	2
9	97381-001	DECAL-DIESEL FUEL ONLY	1
10	97382-000	DECAL-DO NOT USE STARTING FLUIDS	1

GENERATOR SPECIFICATIONS

RESISTANCE VALUES:

STATOR:	G1 - N	.132 OHMS
	G3 - N	.256 OHMS
	CAPACITOR LEADS	.365 OHMS

ROTOR: 2.0 OHMS

WINDING SPEC: SS1533

KEY START INSTALLATION

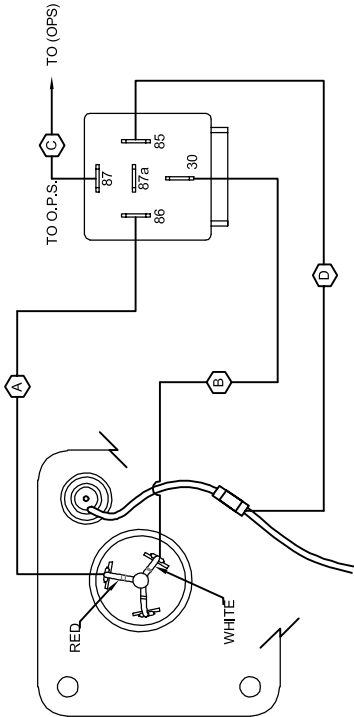
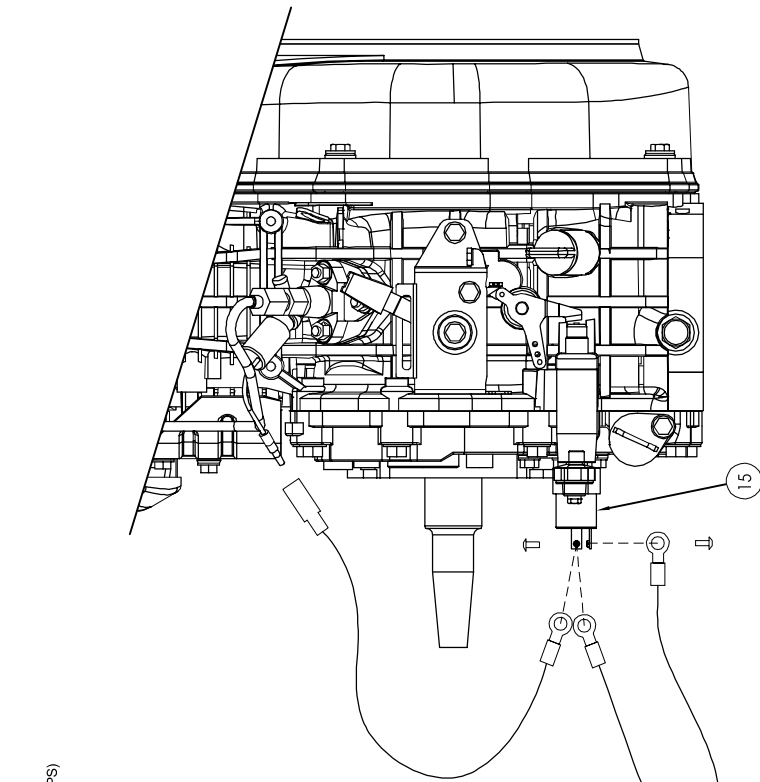

ITEM NO.	PartNo	DESCRIPTION	QTY.
1	15806-020	KEY SWITCH	1
2	15773-000	KEY SWITCH BRACKET A	1
3	15773-001	KEY SWITCH BRACKET B	1
4	21698-001	TORX PAN HEAD SCREW #10	7
5	62912-001	FOAM STRIP .875 WIDE .125 THICK .645ft	
6	59944-016	RELAY 12VDC 30AMP SPDT	1
7	94000-000	RHMS 8-32X1/2	1
8	6376-000	#8 LOCK WASHER	1
9	5113-000	HEX NUT #8-32	1
10	511-000	#8 FLATWASHER	1
11	11067-000	18AWG BLACK	1.75ft
12	48602-003	FEMALE .250 TAB	4
13	4158-000	TERM RING #10 STUD	3
14	58077-000	CLOSED CONNECTOR	1
15	99036-000	OIL PRESSURE SWITCH	1

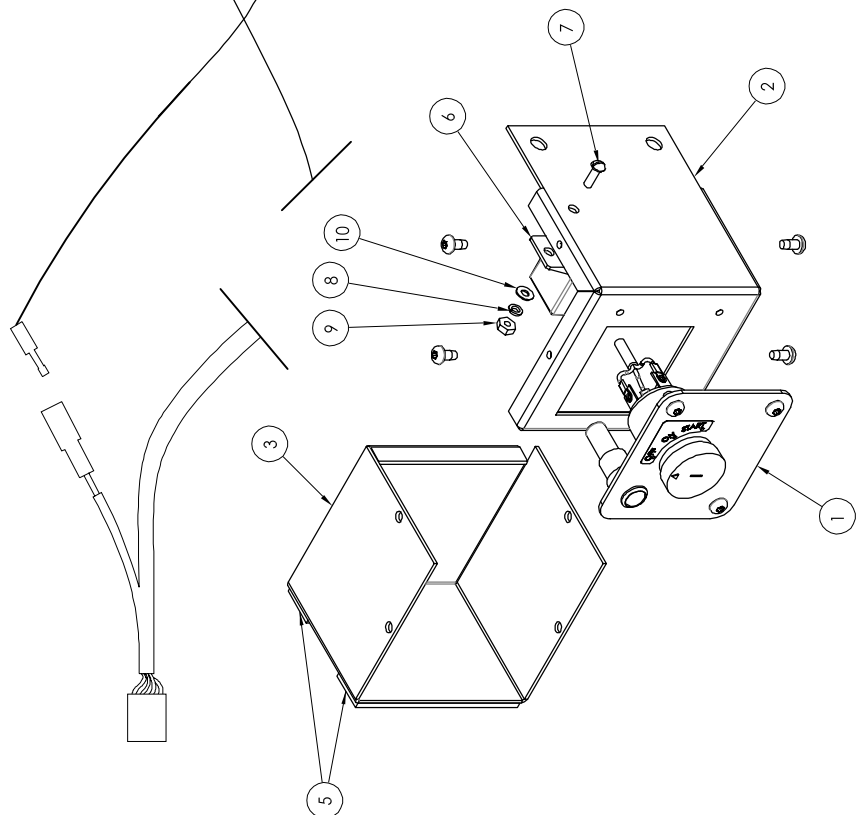

WIRING DIAGRAM & SCHEMATIC

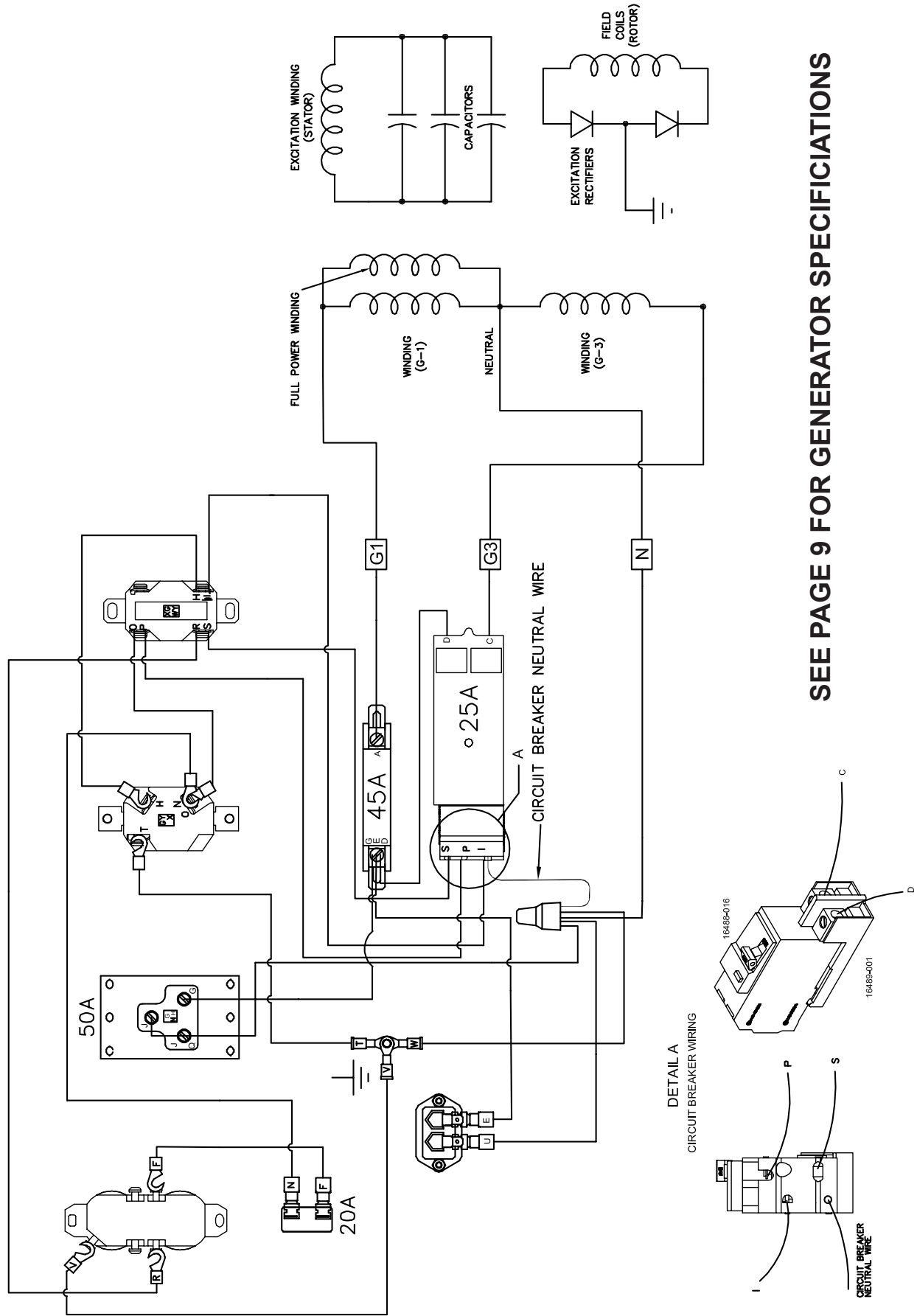

SEE PAGE 9 FOR GENERATOR SPECIFICATIONS

DETAIL A
CIRCUIT BREAKER WIRING