

ILLUSTRATED PARTS LIST

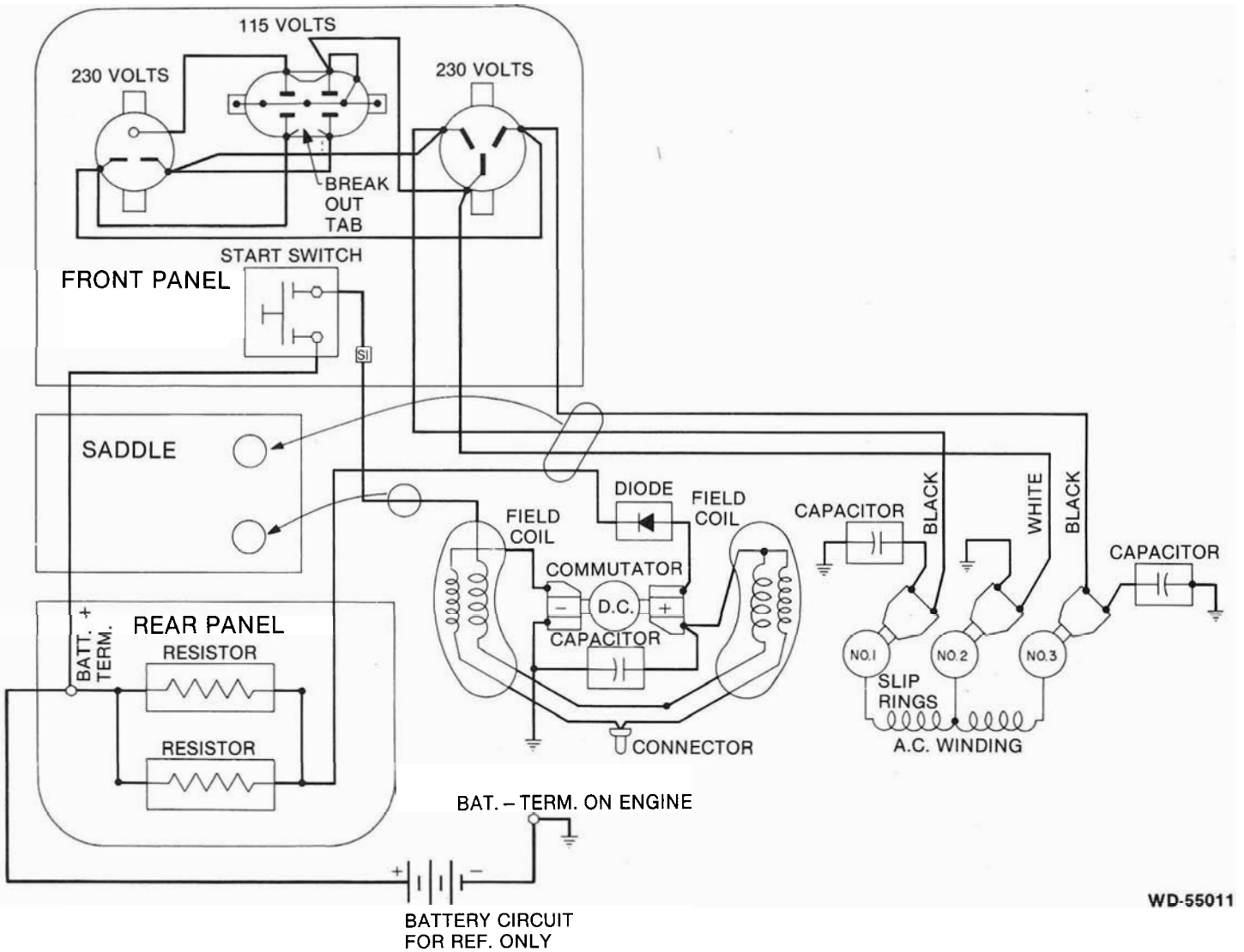

SCHEMATIC DIAGRAM

This IPL contains wiring, illustration, parts list, ordering information and technical data to perform routine maintenance on this generator. Consult factory with model no., serial no. and test data for further assistance.

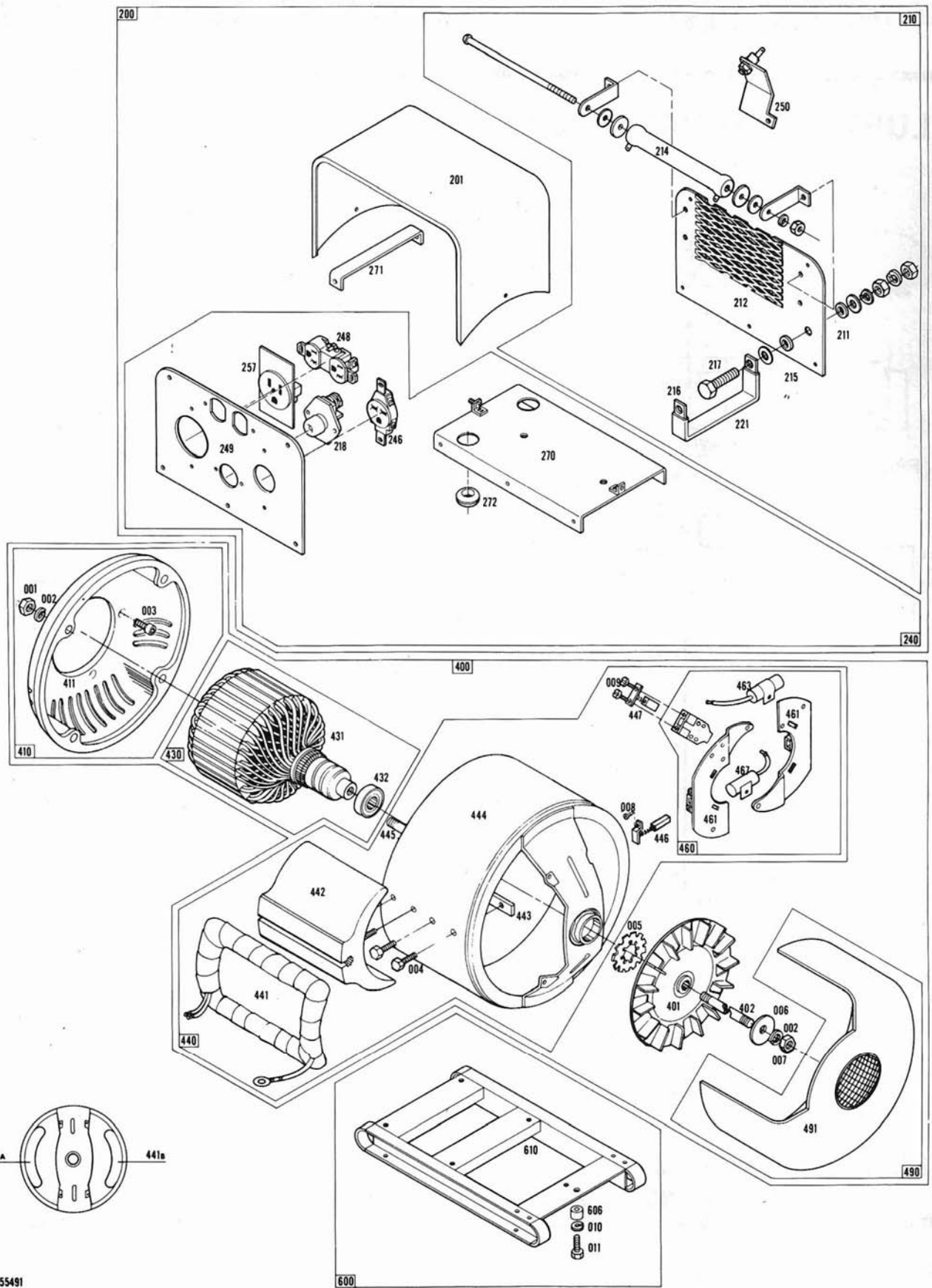

REF. NO.	DESCRIPTION	QTY.	PART NO.	REF. NO.	DESCRIPTION	QTY.	PART NO.
000	Hardware			270	Saddle	1	55005
001	Hex Nut 5/16-18	4	458	271	Brace	2	49974
002	Lockwasher 5/16 Split	5	480	272	Grommet	2	23917
003	Screw Allen Hd.	4	24707				
004	Cap Screw 7/16-20 x 1 3/4	8	43781	400	Generator Assembly		55492
005	Lockwasher 11/16 Int. Tooth	1	40552	401	Fan Assembly	1	23404
006	Flatwasher 11/32 ID x 1 OD	1	23558	402	Thru Bolt	1	24195
007	Hex Nut 5/16-24	1	23605	411	End Bracket	1	55493
008	Mach. Screw 10-24 x 3/8	3	4637	430	Armature Assembly	1	55360
009	Mach. Screw 8-32 x 5/16	24	40746	431	Armature	1	55360-1
010	Lockwasher 1/2 Split	5	636	432	Bearing	1	50215
011	Cap Screw 1/2-13 x 2 1/2	1	21701				
				440	Field Shell & Coil Assembly	1	55494
100	Type Drive Engine Wis. TJD-1 375673	1	47525	441A	Field Coil	1	55359
				441B	Field Coil	1	55359-1
				442	Pole Shoe	2	43473
200	Control Panel	1	55019-1	443	Pole Shoe Retainer	2	43474
201	Cover	1	21626	444	Field Shell & Bracket	1	55340
				445	Stud	4	51434
210	Rear Panel Assembly	1	55022	446	Brush D.C.	2	47683
211	Insulation Washer	1	6892	447	Brush A.C.	12	55536
212	Rear Panel (Bare)	1	54872				
214	Resistor Assembly	2	54599	460	Brush Rack Assembly	1	50656&-1
215	Shoulder Washer	1	21981	461	Riveted Brush Plate LH	1	47684
216	Copper Strap	2	52789-2	462	Brush Holder A.C.	12	23500
217	Machine Screw	1	21974	463	Capacitor A.C.	2	41221
218	Starter Switch	1	2210	465	Riveted Brush Plate RH	1	47684-1
221	Insulation Sleeve	1	54041-1	466	Capacitor D.C.	1	41180
240	Front Panel Assembly	1	55020	600	Base Assembly		
246	Receptacle 250V 15A	1	55278	606	Spacer	1	24780
248	Receptacle (Duplex)	1	24749	610	Base	1	49987
249	Front Panel (Bare)	1	54371				
250	Heat Sink & Rectifier	1	54732				
257	Receptacle 250V 50A	1	57325				

PARTS ORDERING INFORMATION REQUIRED



To fill your order for service parts, please advise the complete Generator model number and serial number, part number(s), and part description. If in doubt, consult the factory prior to placing the order. Send all parts orders to WINCO, Division of Dyna Technology, Inc., 225 South Cordova Ave., Le Center, MN 56057.

TECHNICAL DATA

GENERATOR SPECIFICATIONS:

Watts—10,000; Volts—115/230; Amps.—43.7; PH—1; Hz-60; RPM—3600

Nominal Voltage:	No Load:	Full Load:
115 VAC	132 VAC	112 VAC
230 VAC	264 VAC	224 VAC

Resistance:

Field Coils— $7 \pm .4$ ohms
Armature—Less than 1 ohm ring to ring

Excitation Voltage: Approximately

60 Volts D.C.

BASIC TEST PROCEDURE:

Refer to illustration for component location by Reference Number.

Example: No output—Check field coils for opens or shorts. Reference Numbers 441A and 441B

No Output:

- Check for loose or open connections.
- Check field coils for opens or shorts, Reference Numbers 441A and 441B
- Check brushes for wear, proper seating and not stuck in holder. Reference Numbers 446 and 447
- Check armature for opens or shorts. Reference Number 431

Low Voltage—No Load:

- Check generator speed/frequency (3600 RPM nominal).
- Check for loose or open connections.
- Check winding resistance. Reference Numbers 441A-441B and 431

Low Voltage—Full Load:

- Check generator speed/frequency (3600 RPM nominal).
- Check generator load.
- Check for loose or open connections.
- Check winding resistance. Reference Numbers 441A-441B and 431

SS-1184



Division of
DYNA TECHNOLOGY, INC.
225 South Cordova
Le Center, MN 56057
Phone (612) 357-6821
Telex 290753