

ILLUSTRATED PARTS LIST

IP 4 BH - 3 E/E

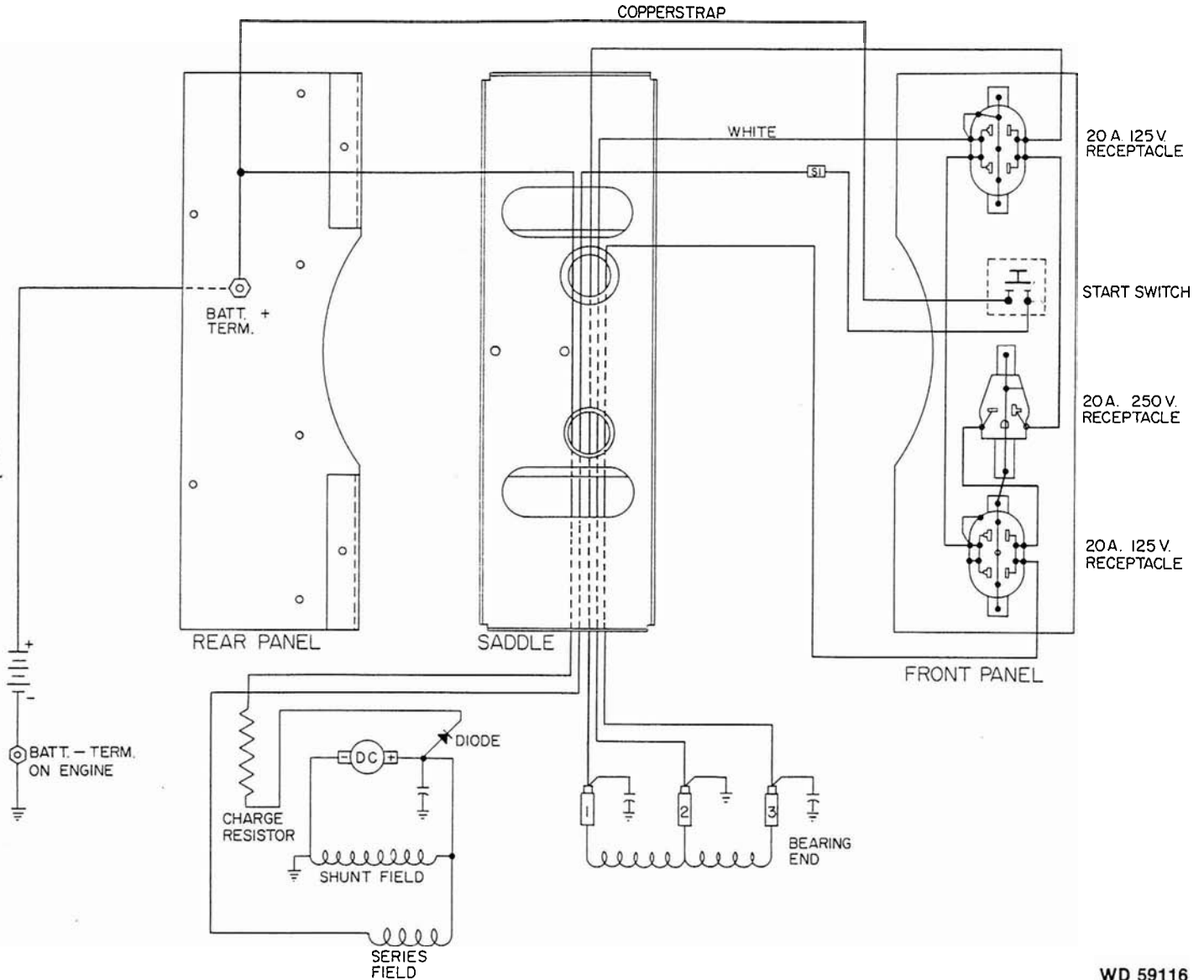

WD 59116

SCHEMATIC DIAGRAM

This IPL contains wiring, illustration, parts list, ordering information and technical data to perform routine maintenance on this generator. Consult factory with model no., serial no. and test data for further assistance.

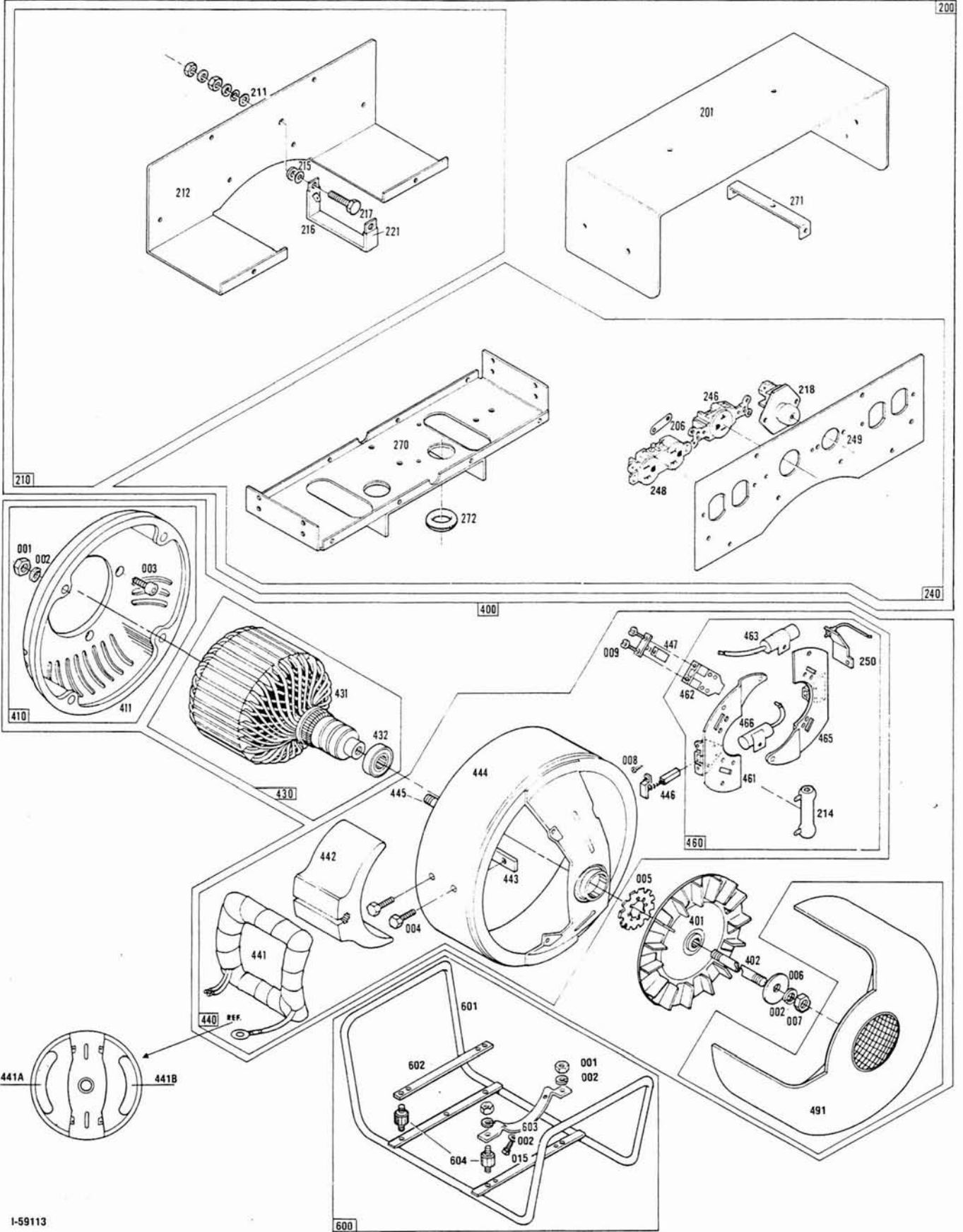

REF. NO.	DESCRIPTION	QTY.	PART NO.	REF. NO.	DESCRIPTION	QTY.	PART NO.
000	Hardware			400	Generator	1	59114
001	Hex Nut 5/16-18	15	458	401	Fan Assembly	1	55101
002	Lockwasher 5/16 Split	18	480	402	Thru Bolt	1	23197-7
003	Cap Screw 3/8-16 x 1 1/4	4	3290	411	End Bracket	1	54178
004	Cap Screw	4	9416				
005	Lockwasher Int. Tooth	1	55224	430	Armature Assembly	1	55317
006	Flat Washer	1	23558	431	Armature	1	55317-1
007	Hex Nut 5/16-24	1	23605	432	Bearing	1	55223
008	Machine Screw 10-32 x 3/8	3	4637				
009	Machine Screw	12	40746	440	Field Shell & Coil Ass'y	1	55421-2
	8-32 x 5/16			441A	Field Coil	1	55422
015	Cap Screw 5/16-18 x 3/4	2	467	441B	Field Coil	1	55422-1
				442	Pole Shoe	2	23207
100	Type Drive Engine B & S 190412-1774-01	1	55177	443	Pole Shoe Retainer	2	23208
				444	Field Shell	1	59067
				445	Stud	4	23451
200	Control Panel Assembly		59115	446	Brush D.C.	2	41393
201	Cover	1	59073	447	Brush A.C.	6	23607
271	Brace	2	51576				
210	Rear Panel Assembly	1	59119	460	Brush Rack Assembly	1	55423
211	Insulation Washer	1	6892	461	Riveted Brush Rack LH	1	41774-400
212	Rear Panel (Bare)	1	59118	462	Brush Holder A.C.	6	23500
215	Shoulder Washer	1	21981	463	Capacitor A.C.	2	41221
216	Copper Strap	1	52789-11	250	Heat Sink & Rectifier	1	54732
217	Machine Screw	1	21974	465	Riveted Brush Rack RH	1	41774-401
221	Insulation Sleeving	1	54041-19	466	Capacitor D.C.	1	41180
240	Front Panel Assembly	1	59117	214	Resistor Batt. Charge	1	41984
206	Ground Strap	3	41387-2				
218	Start Switch	1	2210	600	Cradle Assembly		
246	Receptacle 250 20A	1	57642	601	Cradle	1	58363-1
248	Receptacle 125V 20A	2	50766	602	Flat Bar	1	43292
249	Front Panel (Bare)	1	59088	603	Formed Bracket	1	43291
270	Saddle	1	56926	604	Shock Mount	4	23623
272	Grommet	1	56927	611	Foot (Not Shown)	3	20191

PARTS ORDERING INFORMATION REQUIRED

To fill your order for service parts, please advise the complete Generator model number and serial number, part number(s), and part description. If in doubt, consult the factory prior to placing the order. Send all parts orders to WINCO, Division of Dyna Technology, Inc., 225 South Cordova Ave., Le Center, MN 56057.



TECHNICAL DATA

GENERATOR SPECIFICATIONS:

Watts—4000; Volts—115/230; Amps.—17.4; PH—1; Hz—60; RPM 3600

Nominal Voltage:	No Load	Full Load
115 VAC	132 VAC	112 VAC
230 VAC	264 VAC	224 VAC

Resistance:

Field Coils— $2.27 \pm .12$ ohms

Armature—Less than one ohm ring to ring

Excitation Voltage: Approximately

28 Volts DC

Separately Excited:

12 VDC to Positive Field Lead, 50 to 70 VAC output

NOTE: Remove positive DC brush. Unit will have to be started manually.

BASIC TEST PROCEDURE:

Refer to illustration for component location by reference number.

Example: No output—Check field coils for opens and shorts, Reference Numbers 441A and 441B

No Output:

- Check for loose or open connections.
- Check field coils for opens or shorts, Reference Numbers 441A and 441B
- Check brushes for wear, proper seating and not stuck in holder, Reference Numbers 446 and 447
- Check armature for opens or shorts, Reference Number 431

Low Voltage—No Load:

- Check generator speed/frequency (3600 RPM nominal).
- Check for loose or open connections.
- Check winding resistance, Reference Numbers 441A-441B and 431

Low Voltage—Full Load:

- Check generator speed/frequency (3600 RPM nominal).
- Check generator load.
- Check for loose or open connections.
- Check winding resistance, Reference Numbers 441A-441B and 431.

WINGCO[®]

Division of
DYNA TECHNOLOGY, INC.
225 South Cordova
Le Center, MN 56057
Phone (612) 357-6821
Telex 290753