

24018-007

ITEM NO.	PartNo	DESCRIPTION	QTY.	KIT
1	466-000	.25-20X.75 HHB	3	
2	479-000	LOCK WASHER, .25" SPLIT	3	
3	512-000	.25 WASHER	3	
4	15163-101	FUEL SYSTEM ASSEMBLY	1	
5	15209-001	GASOLINE DECAL	1	*
6	15209-002	DECAL-DANGER CARBON MONOXIDE	1	*
7	15209-003	UL-DECAL ELECTRICAL SHOCK CAN KILL	1	*
8	15209-013	DECAL - FUEL TYPE GASOLINE	1	
9	15209-036	PROP 65 WARNING DECAL	1	
10	15209-101	DECAL, GASOLINE DANGER, FRENCH	1	**
11	15209-102	DECAL-DANGER CARBON MONOXIDE	1	**
12	15209-103	UL-DECAL ELECTRICAL SHOCK CAN KILL	1	**
13	15457-071	RECEPTACLE PANEL ASSEMBLY	1	
14	16329-001	RUBBER STRAP, BATTERY HOLD DOWN	1	
15	18000-035	ENGINE GENERATOR ASSEMBLY	1	
16	18000-208	WL22000 HARDWARE KIT	1	
17	21698-001	TORX PAN HEAD SCREW #10	2	
18	60710-018	OIL WARNING TAG	1	
19	63966-004	NAMEPLATE, WINCO PORTABLE	1	
20	64918-000	DECAL-DANGER (CO) USE OUTSIDE	1	
21	94442-002	NUT HEX M6-1.0	4	
22	96286-002	FLAT WASHER NYLON	2	
23	100047-776	CARTON, 43.5 X 30.5 X 29.5	1	
24	100054-514	BAG 54 X 52 X 60 1.0 MIL	1	
25	100059-005	PALLET, 44X31	1	
26	300144-26	LIFTING EYE ASSEMBLY WL22000	1	
27	300216-40	LEFT SIDE PANEL ASSEMBLY	1	
28	300217-30	RIGHT SIDE PANEL	1	
29	300515-2	OIL	2.5 QTS	
30	OPM-153	OPERATORS MANUAL	1	
31	16200-511	MAINT KIT DECAL	1	
32	15209-014	DECAL - CHECK OIL	1	

PARTS IN KIT:
 * 15209-000
 ** 15209-100

REVISIONS					
REV.	IRN	DESCRIPTION	DATE	BY	APP'D
A	P280	ORIGINAL	4/24/2019	SJM	SJM
B	CA11233	ADDED PICTURE FOR REFERENCE	6/3/2020	TDS	PAK

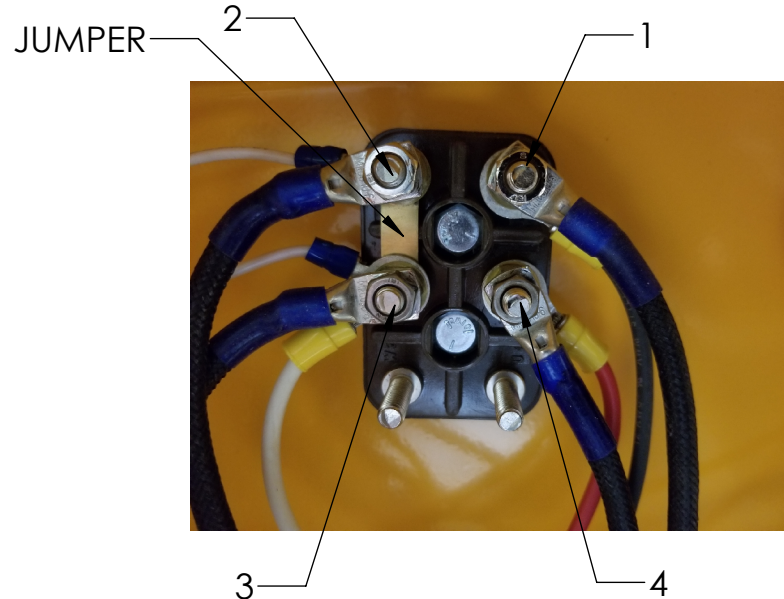
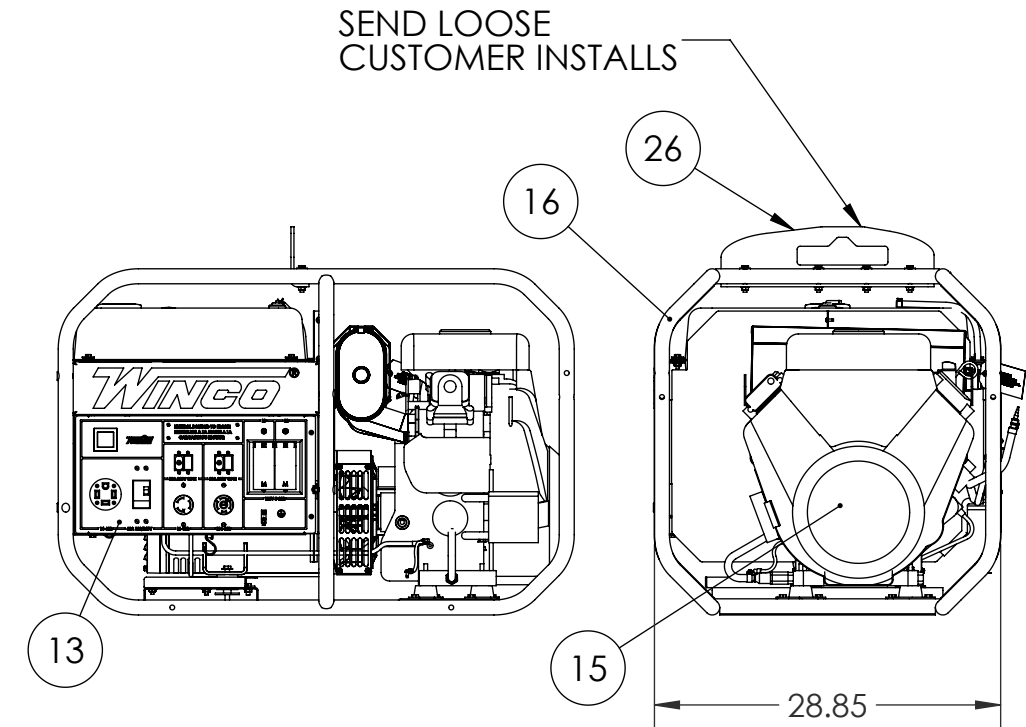
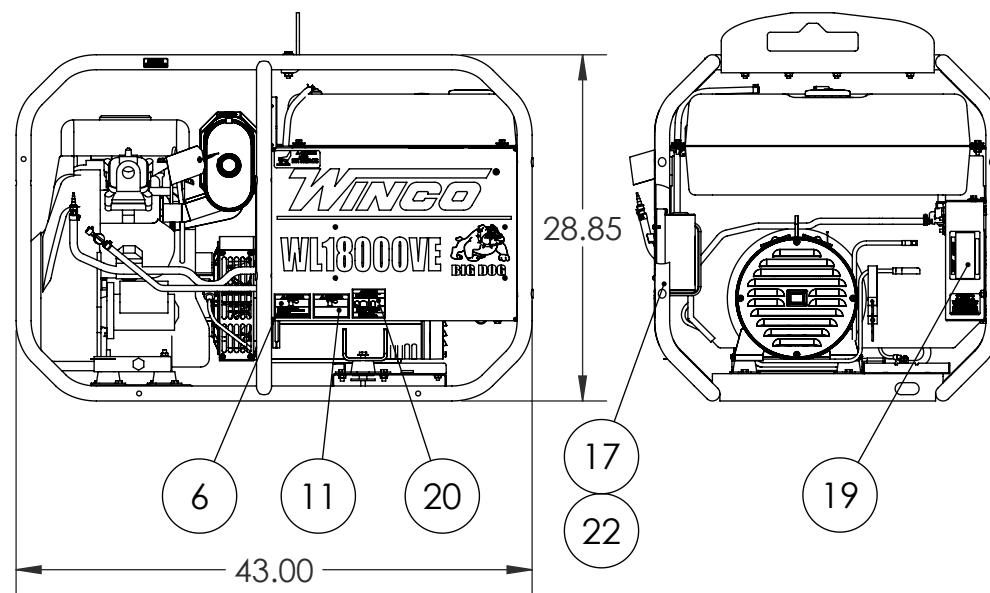
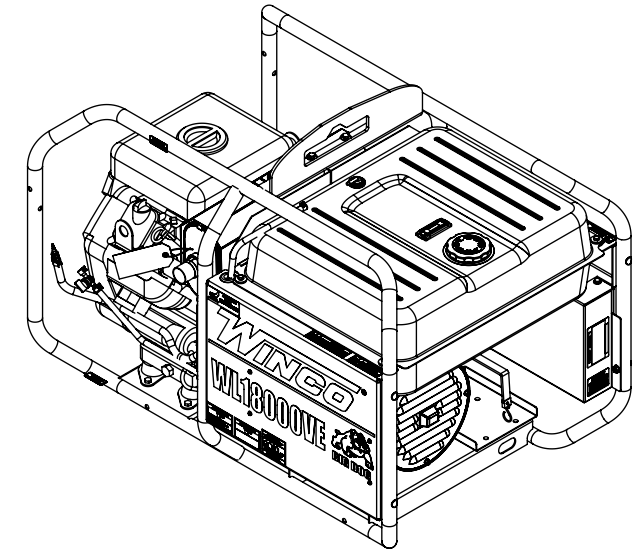
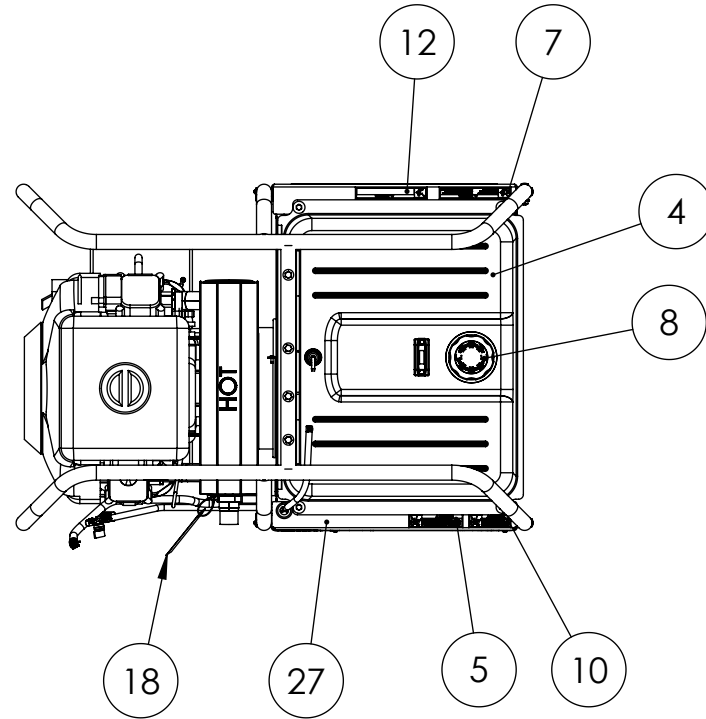

 THIS DRAWING CONTAINS PROPRIETARY INFORMATION BELONGING TO WINCO. UNAUTHORIZED USE IS PROHIBITED. ALL DIMENSIONS INCH	DRAWN BY	DATE	CHK'D BY	DATE	ENG APPR.	DATE
	SJM	04/24/2019			SJM	3/26/2020
	TOLERANCE:	+/- 0.0625 DECIMAL		TITLE:		
	MODEL:	+/- 1 DEG ANGULAR		WL18000VE-03/B		
	WINCO®		PART:	24018-007	1 of 1	